

INSTALLED 12/79

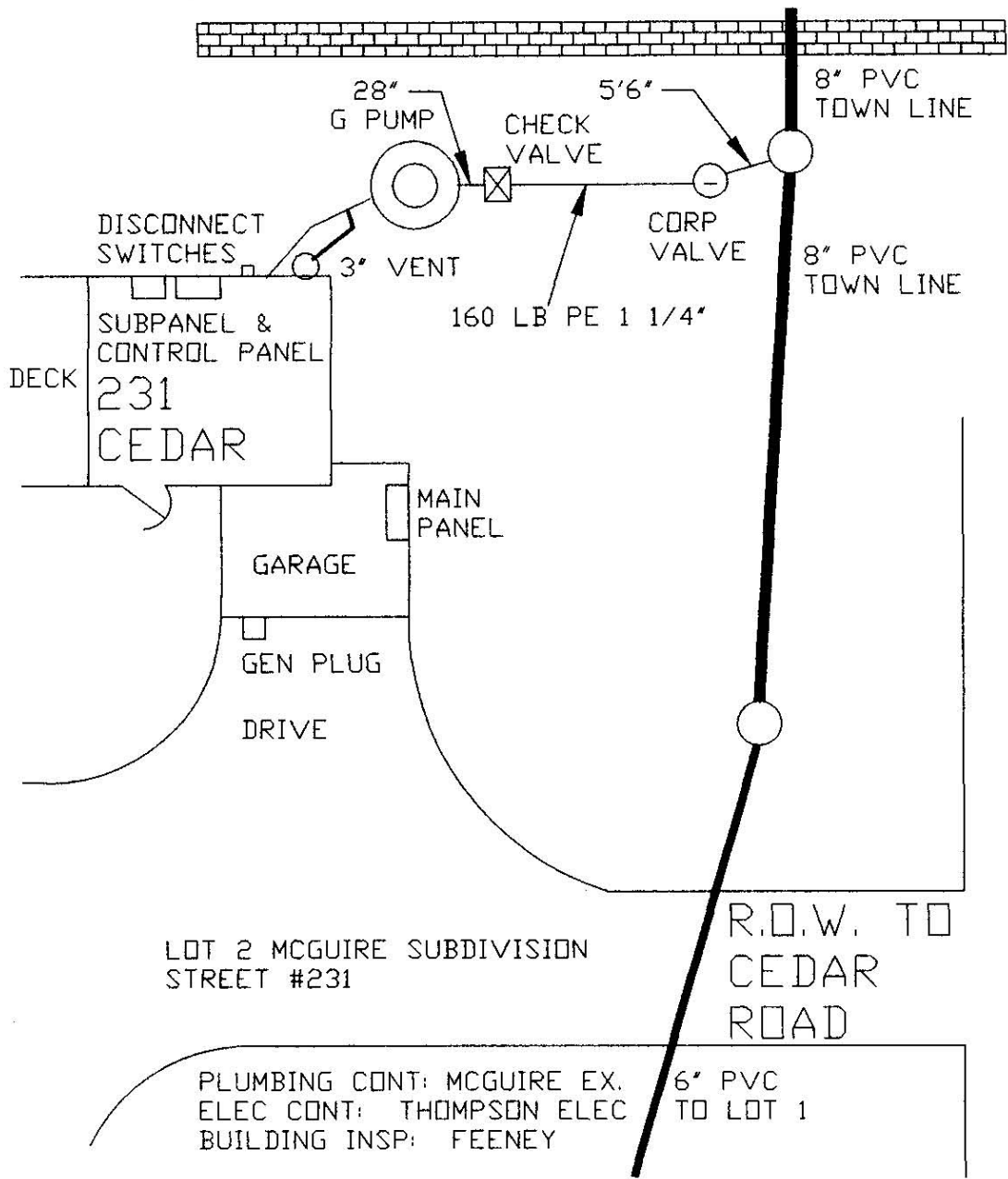

LOT 2 MCGUIRE SUBDIVISION
STREET #231

R.O.W. TO
CEDAR
ROAD

CEDAR ROAD

PLUMBING CONT: MCGUIRE EX.
ELEC CONT: THOMPSON ELEC
BUILDING INSP: FEENEY

6" PVC
TO LOT 1

REVISIONS 	<p>GRINDER PUMP SKETCH</p> <p>ADDRESS: 231 CEDAR ROAD MYSTIC</p> <p>OWNER: MOORE</p>	<p>TOWN OF GROTON WPCD GARY CT, GROTON</p>
DWG: CEDAR231		