

EXISTING SIGN TABLE with columns for KEY, QUAN, DESCRIPTION, TYPE. Lists various signs like MYSTIC SHIPYARD WALL, SHIPYARD OFFICE WALL, etc.

SITE DATA table with columns for REQUIREMENT, REQUIRED/ALLOWED, PROVIDED. Includes LOT AREA, LOT WIDTH, AREA OF SITE, etc.

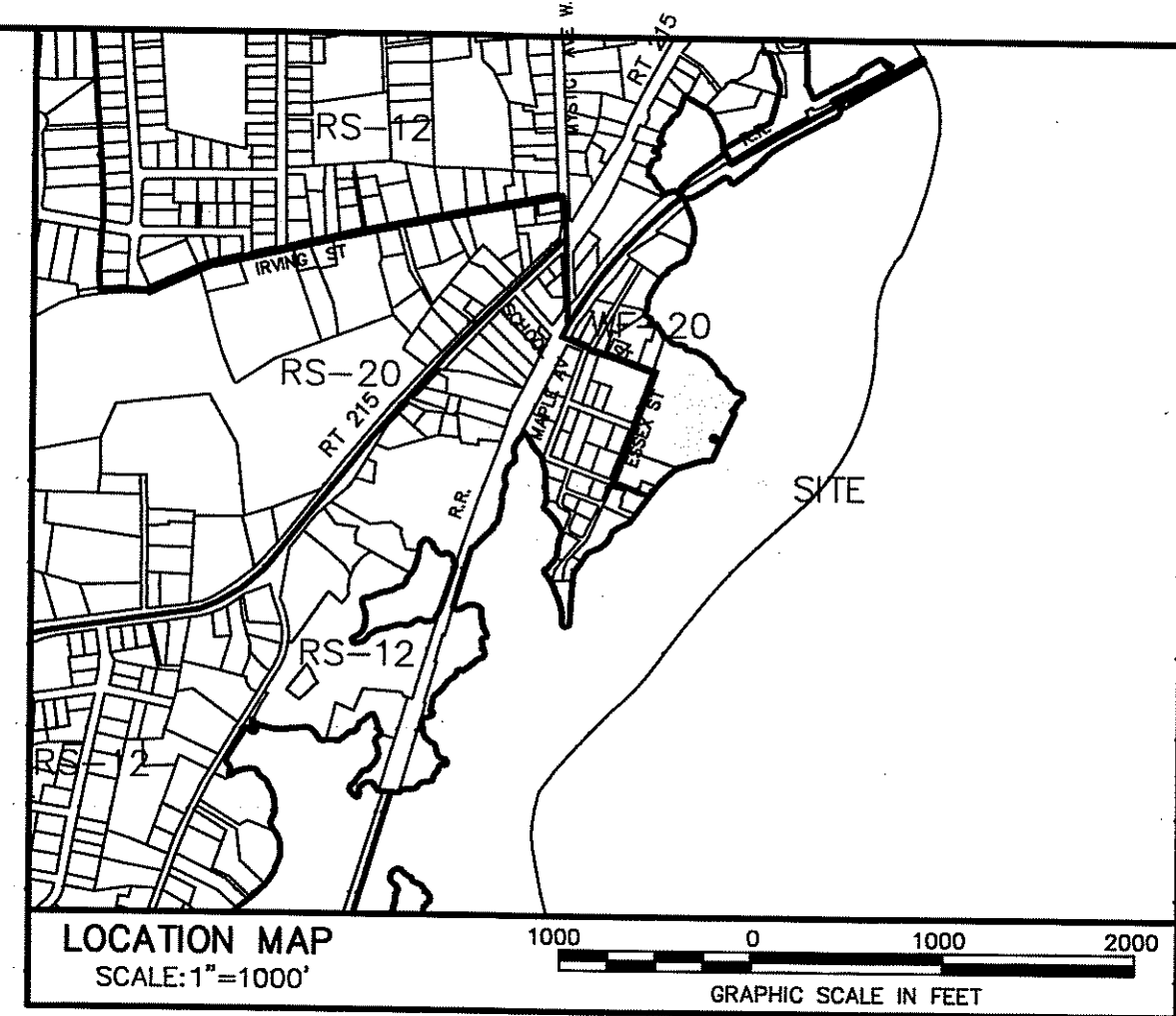

REVISIONS table with columns for NO, DATE, DESCRIPTION, BY. Lists planning commission approval and staff review comments.

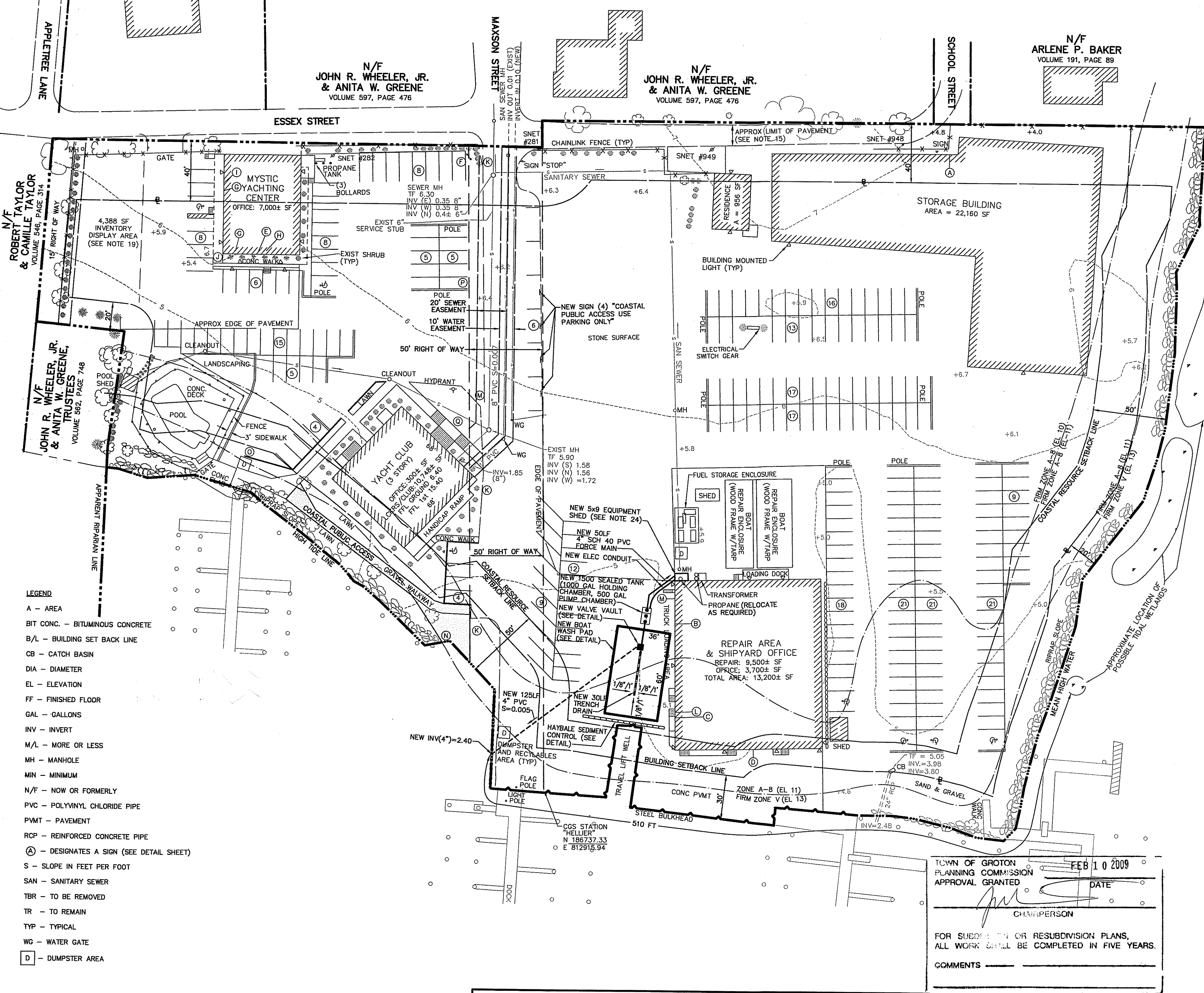

SURVEY NOTES (1-14), MAP REFERENCES (A-F), SITE PLAN NOTES (1-3), BUILDING COVERAGE (A-F), FLOOR AREA SUMMARY (A-F), PARKING (A-C), and TOWN OF GROTON PLANNING COMMISSION APPROVAL GRANTED stamp dated FEB 10 2009.

DICESARE BENTLEY ENGINEERS / SURVEYORS / PLANNERS logo and address: 100 FORT HILL ROAD, GROTON, CT 06340.

PLAN TO ACCOMPANY APPLICATION FOR A SITE PLAN MODIFICATION. NEW BOAT WASH PAD AND NEW BOAT WASH APPLICATION BY: MYSTIC SHIPYARD LLC. PROPERTY OF: MYSTIC SHIPYARD LLC. ESSEX STREET AND MAXSON STREET, GROTON, CONNECTICUT.

REVIEWED AND APPROVED BY THE TOWN OF GROTON PLANNING COMMISSION IN ACCORDANCE WITH THE REQUIREMENTS FOR A COASTAL SITE PLAN REVIEW UNDER SECTIONS 11 THROUGH 15 OF PUBLIC ACT 79-535 ON FEBRUARY 10, 2009.

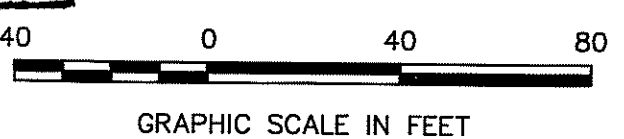

THIS IS AN ORIGINAL INK ON MYLAR. PREPARED BY DICESARE-BENTLEY ENG., INC.



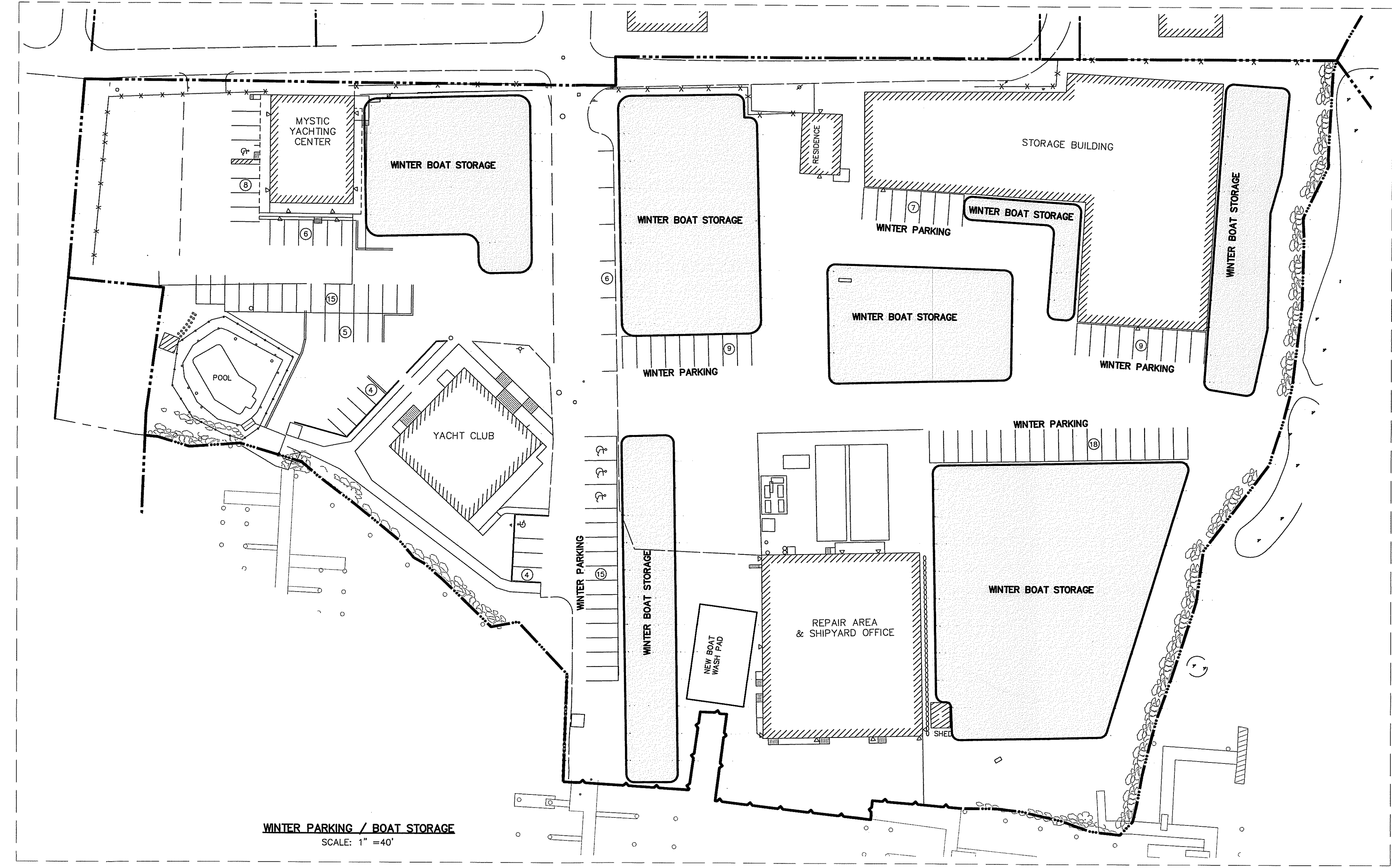

WINTER PARKING / BOAT STORAGE  
SCALE: 1" = 40'

TOWN OF GROTON  
PLANNING COMMISSION  
APPROVAL GRANTED FEB 10 2009 DATE

CHAIRPERSON

FOR SUBDIVISION OR RESUBDIVISION PLANS,  
ALL WORK SHALL BE COMPLETED IN FIVE YEARS.

COMMENTS

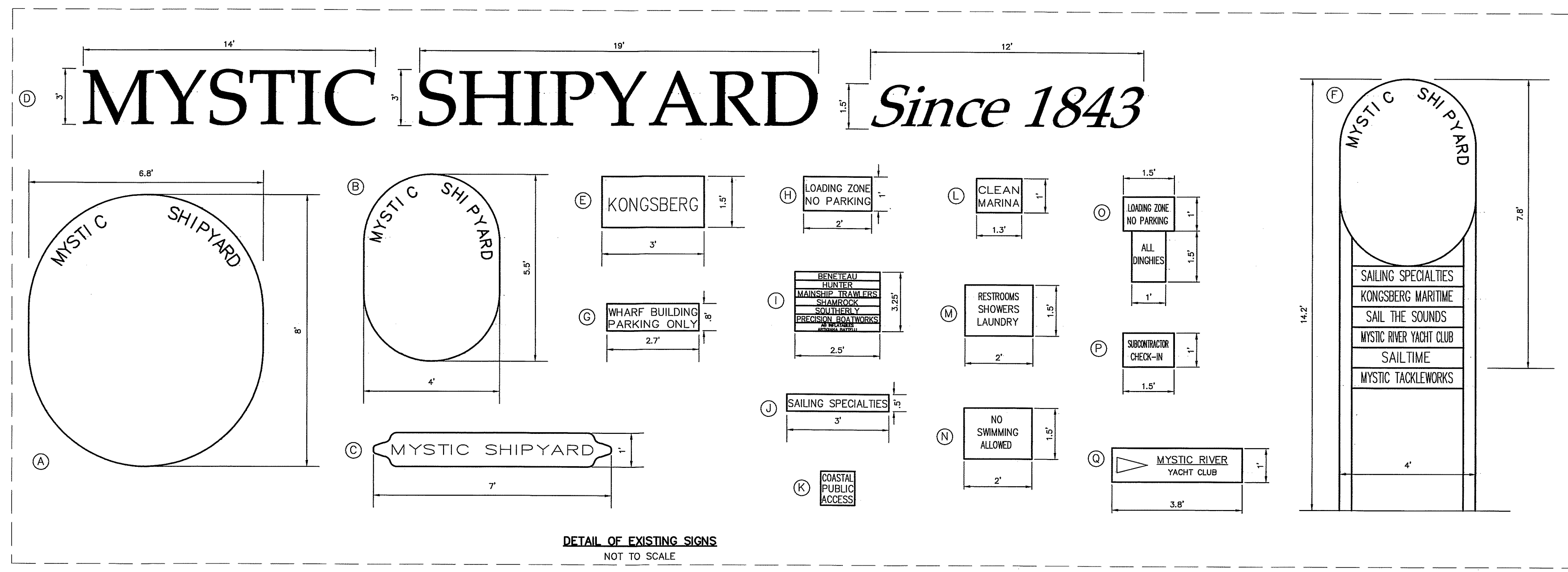

DETAIL OF EXISTING SIGNS  
NOT TO SCALE

THIS IS AN ORIGINAL  
INK ON MYLAR

PREPARED BY  
DICESARE-BENTLEY ENG., INC.

NO	DATE	DESCRIPTION	BY
2	2-18-09	PLANNING COMMISSION APPROVAL CONDITIONS	HEC
1	2-9-09	STAFF REVIEW COMMENTS	HEC

REVISIONS

COPYRIGHT © BENTLEY ENGINEERS, INC.  
ALL RIGHTS RESERVED. NO PART OF THIS DOCUMENT OR ANY OTHER MATERIALS CONTAINED HEREIN MAY BE REPRODUCED OR TRANSMITTED IN ANY FORM OR BY ANY MEANS, WITHOUT THE WRITTEN CONSENT OF THE ENGINEER.

**DICESARE BENTLEY**  
ENGINEERS / SURVEYORS / PLANNERS

100 FORT HILL ROAD GROTON, CT 06340  
PH (860) 448-0400 FX (860) 448-0899  
WWW.DBENGINEERS.COM

TITLE:  
PLAN TO ACCOMPANY APPLICATION FOR A  
SITE PLAN MODIFICATION  
DETAILS  
NEW BOAT WASH PAD  
APPLICATION BY: MYSTIC SHIPYARD LLC  
PROPERTY OF: MYSTIC SHIPYARD LLC  
FORMERLY MYSTIC SHIPYARD, INC.  
ESSEX STREET AND MAXSON STREET  
GROTON, CONNECTICUT

DATE: DECEMBER 12, 2008  
SCALE: 1" = 40'  
DESIGNED BY: HEC  
DRAWN BY: HEC  
CHECKED BY: CBS  
JOB NO: 98-092  
SHEET NO:

**2 OF 3**

DWG NO: 98-092.25

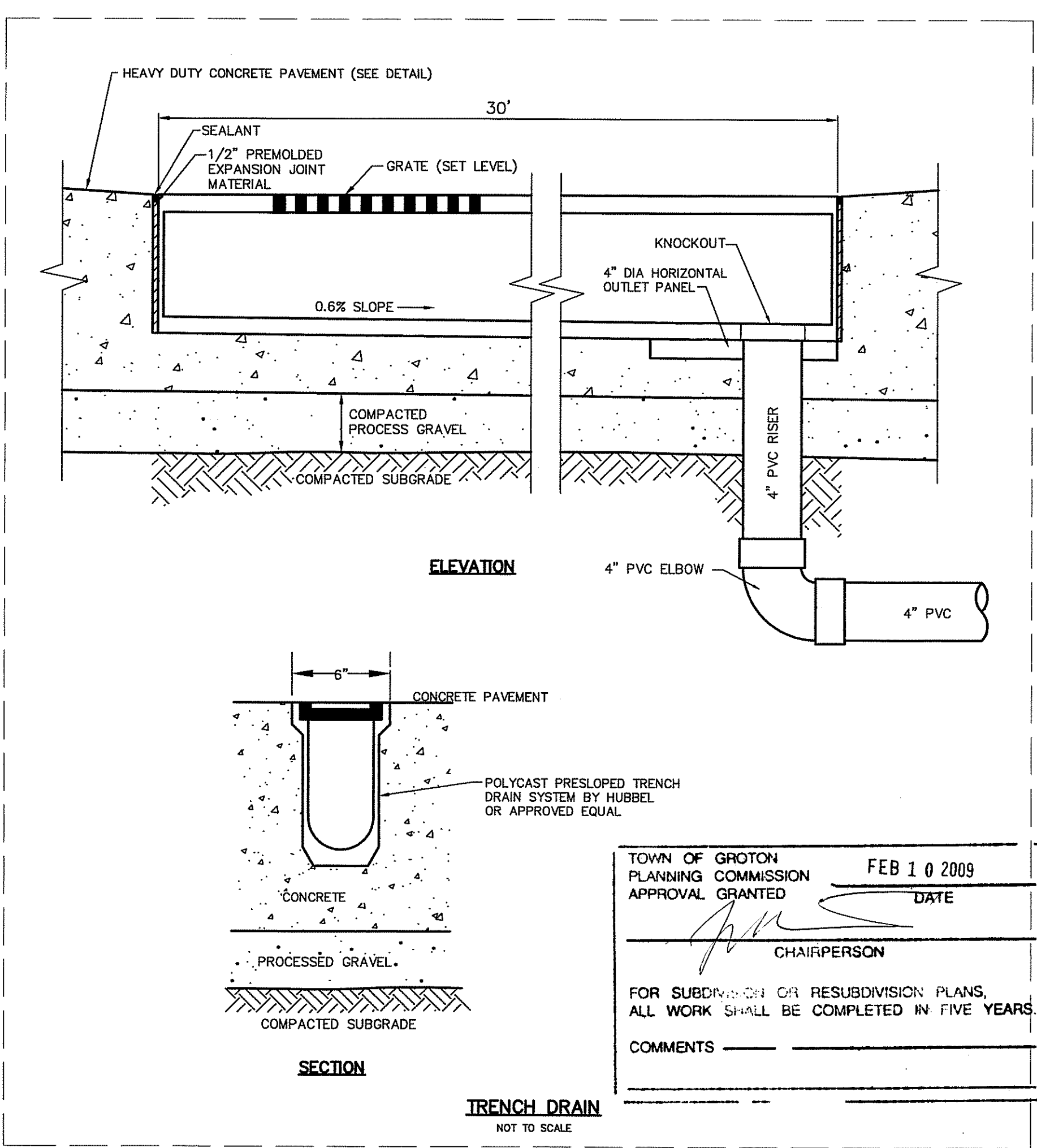
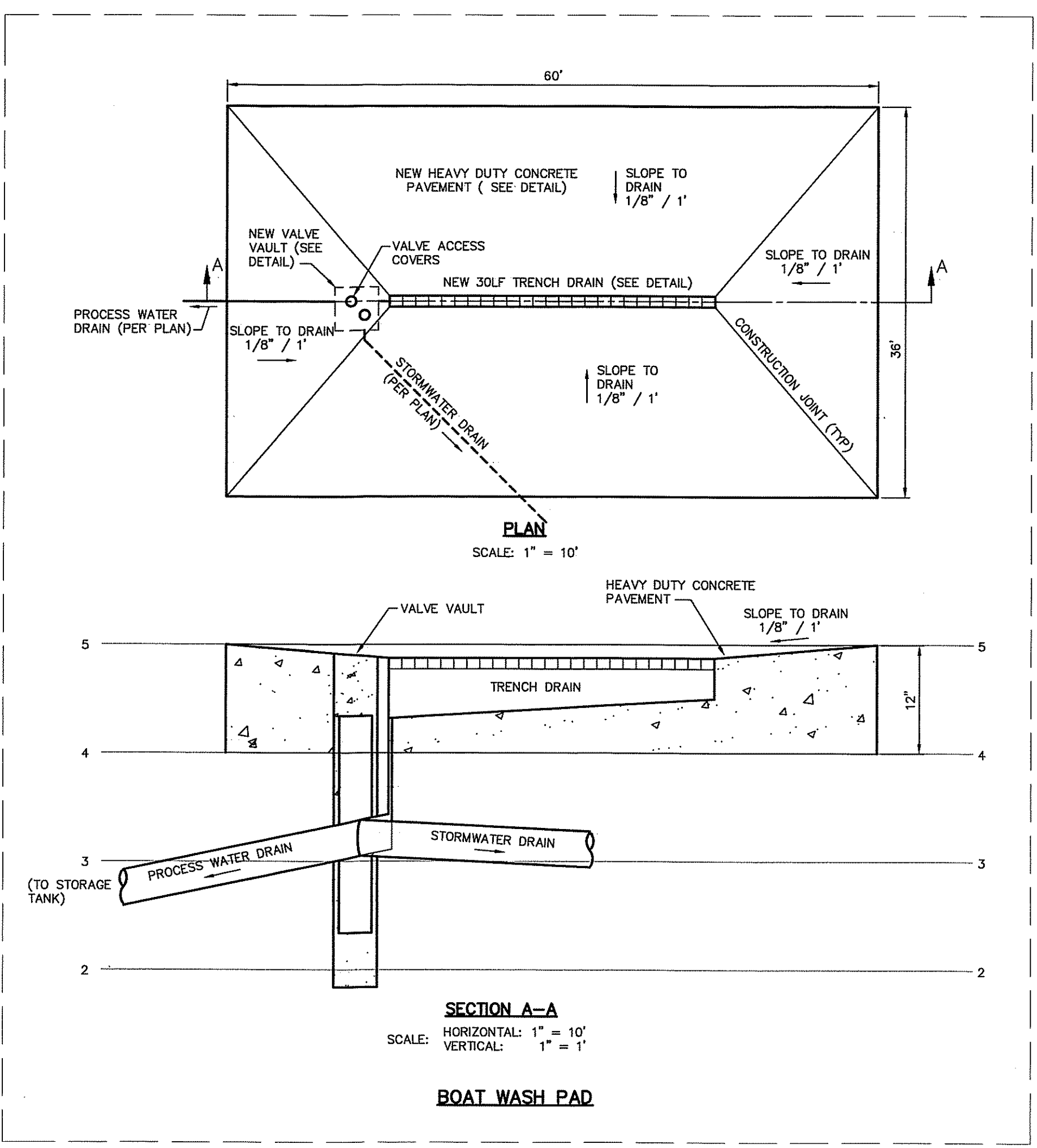

TOWN OF GROTON  
PLANNING COMMISSION  
APPROVAL GRANTED FEB 10 2009  
CHAIRPERSON

FOR SUBDIVISION OR RESUBDIVISION PLANS,  
ALL WORK SHALL BE COMPLETED IN FIVE YEARS.

COMMENTS

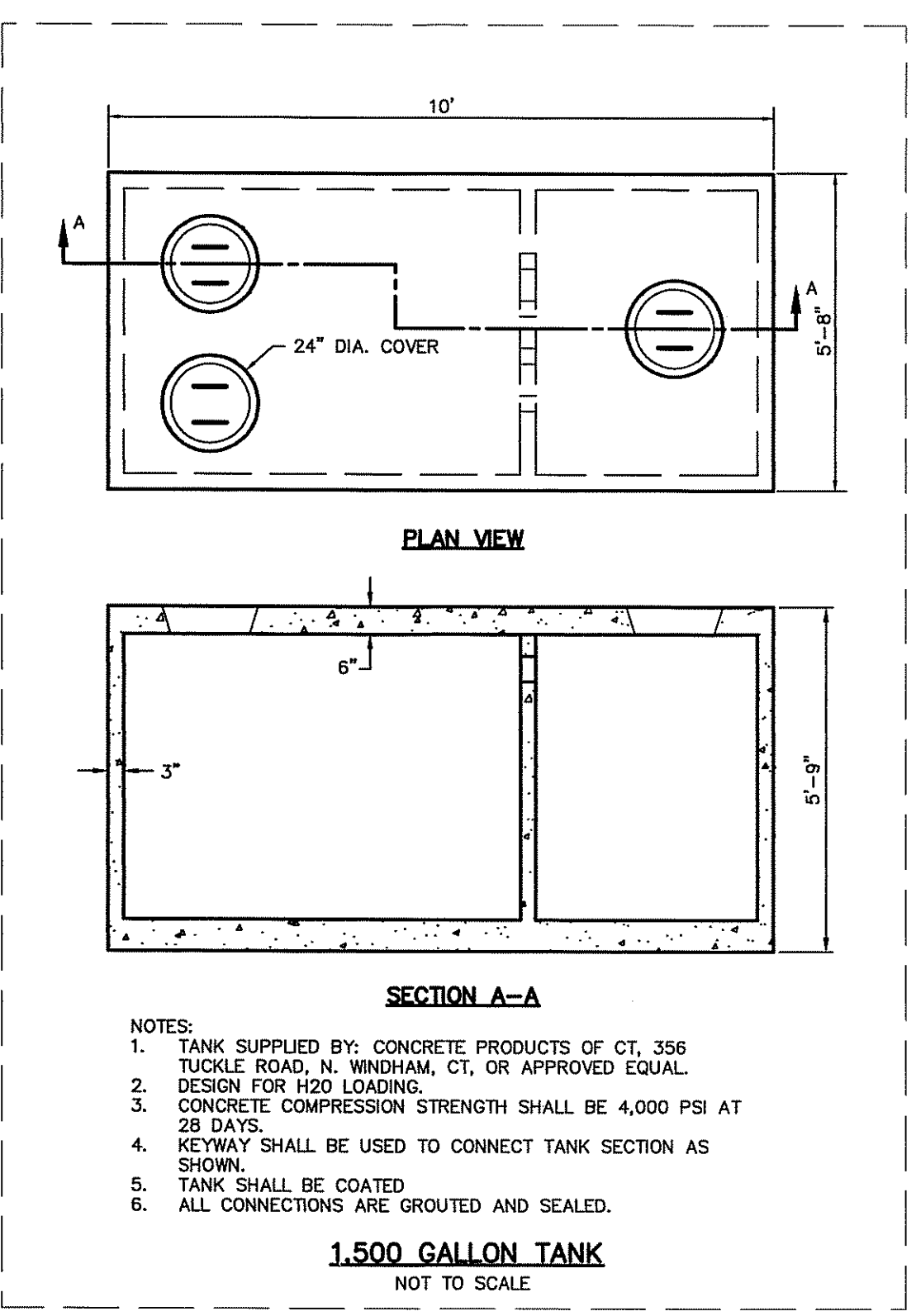
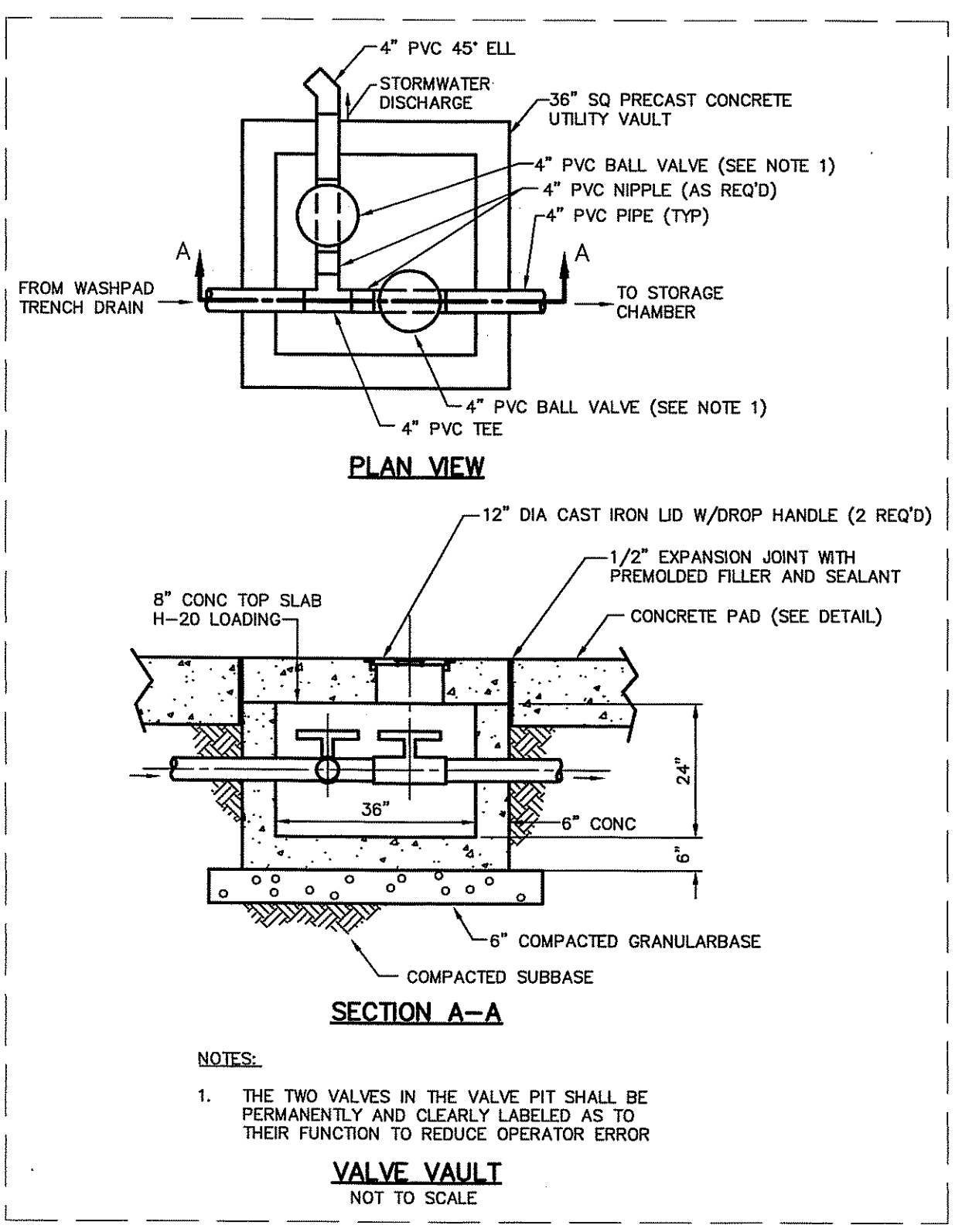
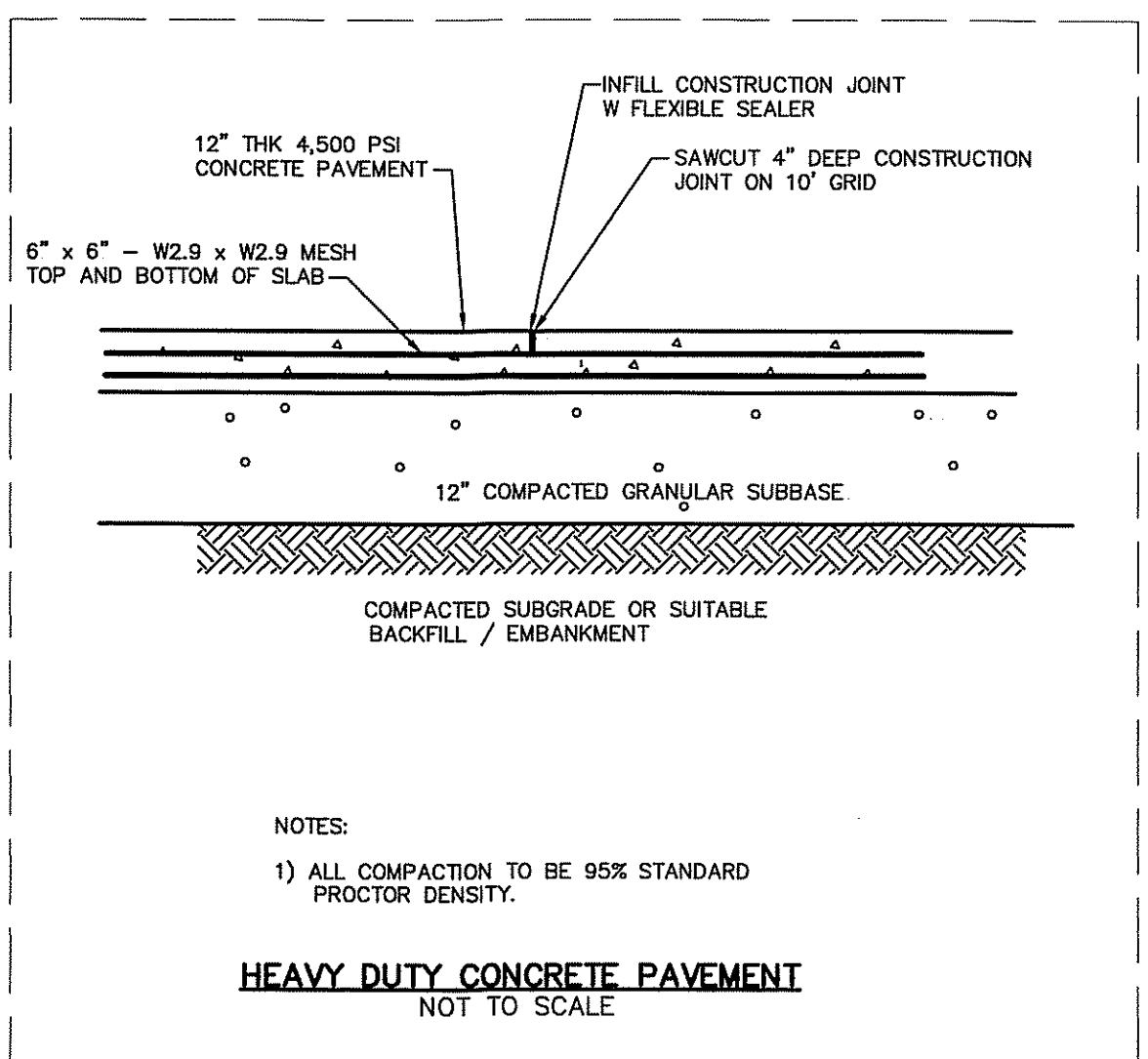
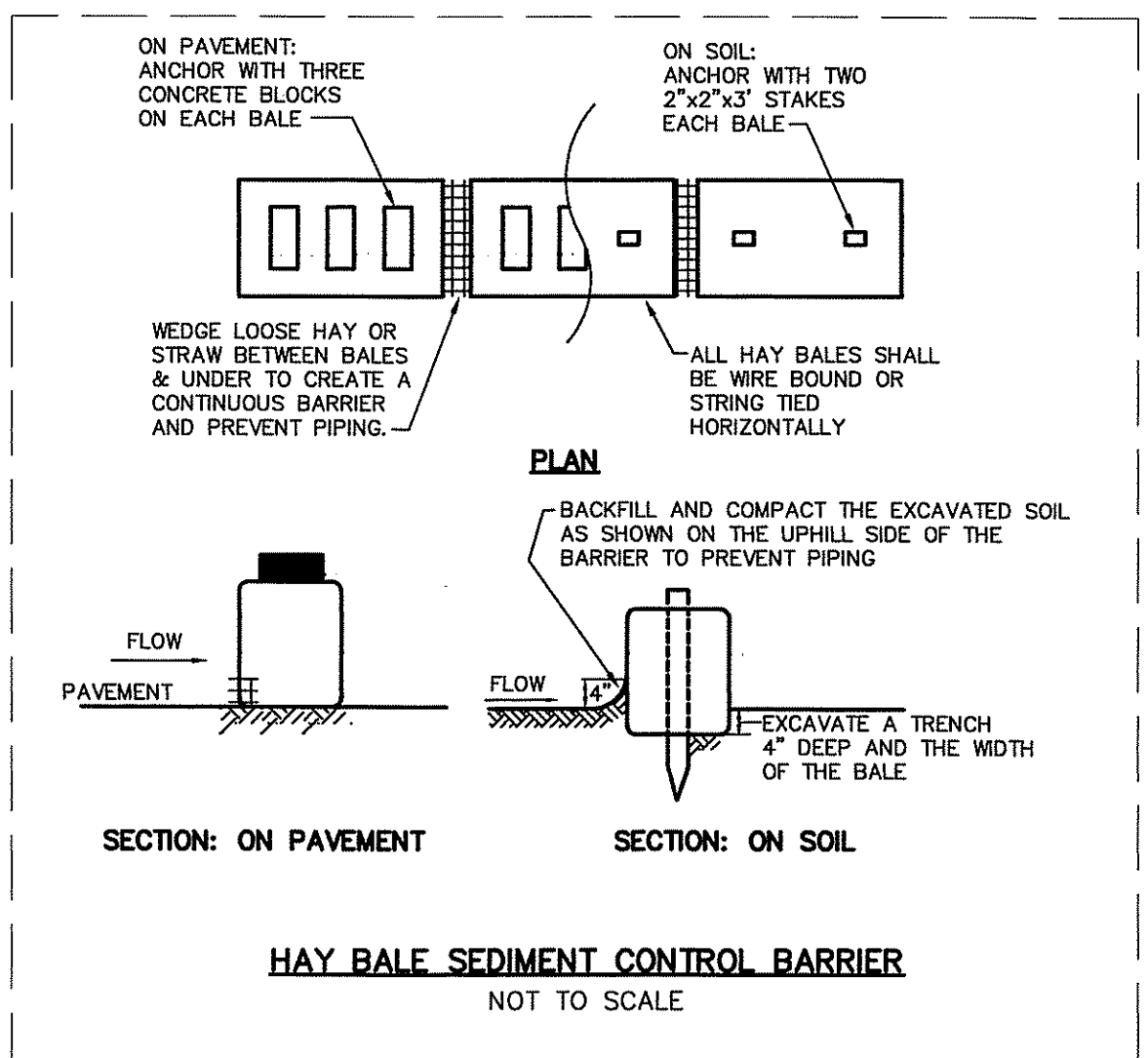

TITLE: PLAN TO ACCOMPANY APPLICATION FOR A SITE PLAN MODIFICATION DETAILS  
NEW BOAT WASH PAD  
APPLICATION BY: MYSTIC SHIPYARD LLC  
PROPERTY OF: MYSTIC SHIPYARD, LLC  
FORMERLY MYSTIC SHIPYARD, INC.  
ESSEX STREET AND MAXSON STREET  
GROTON, CONNECTICUT

DATE: FEBRUARY 18, 2009  
SCALE: 1" = 40'  
DESIGNED BY: HEC  
DRAWN BY: HEC  
CHECKED BY: CSS  
JOB NO: 99-092  
SHEET NO:

3 OF 3

THIS IS AN ORIGINAL  
INK ON MYLAR  
PREPARED BY  
DICESARE-BENTLEY ENG., INC.

NO	DATE	DESCRIPTION	BY
2	2-18-09	ADDED SHEET, PLANNING COMMISSION APPROVAL CONDITIONS	HEC

REVISIONS

COPYRIGHT © DICESARE-BENTLEY ENGINEERS, INC.  
THESE DRAWINGS ARE THE PROPERTY OF THE ENGINEER AND HAVE BEEN PREPARED SPECIFICALLY FOR THE OWNER FOR THIS PROJECT. NO OTHER REUSE, REPRODUCTION OR DISTRIBUTION OF THESE DRAWINGS IS PERMITTED WITHOUT WRITTEN CONSENT OF THE ENGINEER.

**DICESARE-BENTLEY**  
ENGINEERS / SURVEYORS / PLANNERS  
100 FORT HILL ROAD GROTON, CT 06340  
PH (860) 448-0400 FX (860) 448-0899  
WWW.DBENGINEERS.COM