

NOTE:

TRASH GENERATED BY THIS FACILITY WILL BE CO-DISPOSED WITH THE NON-RECYCLABLE WASTES FROM THE SORTING LINE. THE CONTAINERS FOR THIS MATERIAL ARE WITHIN THE NEW PROCESSING SIDE OF THE BUILDING.

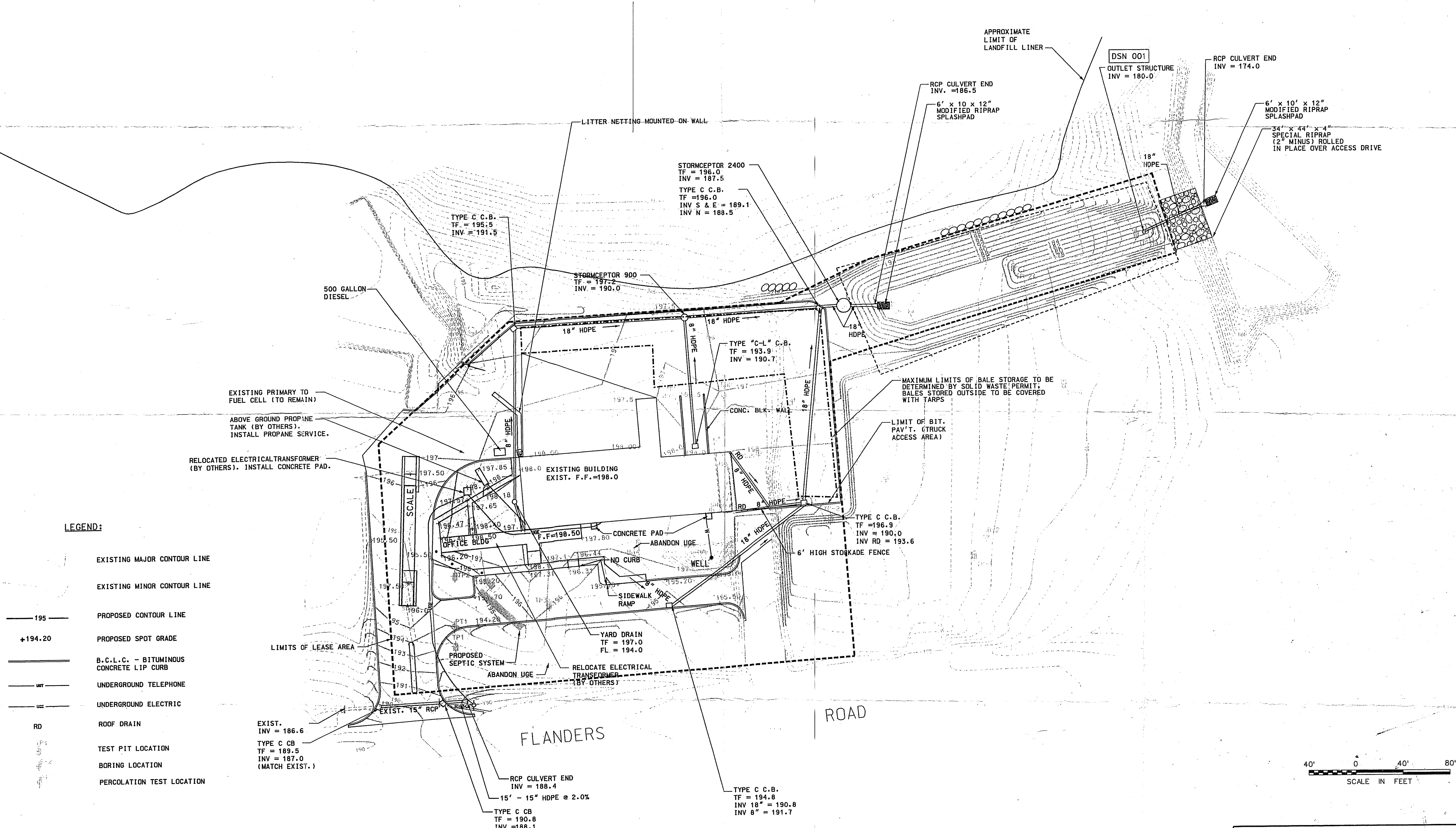

LEGEND:

- 195 — EXISTING MAJOR CONTOUR LINE
- 194.20 — EXISTING MINOR CONTOUR LINE
- +194.20 — PROPOSED CONTOUR LINE
- — PROPOSED SPOT GRADE
- B.C.L.C. — BITUMINOUS CONCRETE LIP CURB
- UT — UNDERGROUND TELEPHONE
- — UNDERGROUND ELECTRIC
- RD ROOF DRAIN
- TEST PIT LOCATION
- BORING LOCATION
- PERCOLATION TEST LOCATION

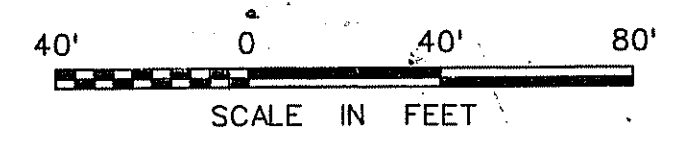

MAP REFERENCE:

SCRRRA - GROTON REGIONAL RECYCLING FACILITY MRF REHABILITATION AND EXPANSION, GRADING, DRAINAGE AND UTILITIES, GROTON, CONNECTICUT, PROJECT NO. 037-08 DATED 10/13/97 REV. 11/17/97, 1"=40' SHEET SP3 BY ANCHOR ENGINEERING SERVICES INC.

		Anchor Engineering Services, Inc.	
		75 Nutmeg Lane Glastonbury, CT 06033 TEL (860) 633-8770 FAX (860) 633-5971	
PROJ. ENGINEER	DS	SCRRRA - GROTON REGIONAL RECYCLING FACILITY STORM WATER POLLUTION PREVENTION PLAN GROTON CONNECTICUT	
PROJ. MANAGER	MMZ		
OFFICE REVIEW	MMZ		
REVISIONS		PROJECT	DATE
		116-09	05/25/04
SCALE: 1" = 40'		SHEET NO.	1