

CURVE #1 DATA	
Δ	9°12'02"
T	97.720'
L	193.813'
R	613.833'
P.C.C.	STA. 11+39.66 N 5632.854 E 4790.581
P.I.	N 5536.795 E 4808.518
P.T.	STA. 13+33.48 N 5451.054 E 4855.396

CURVE #2 DATA	
Δ	12°11'31"
T	156.791'
L	302.448'
R	465.000'
P.C.	STA. 14+96.73 N 5307.815 E 4933.713
P.I.	N 5170.242 E 5008.929
P.T.	STA. 17+99.18 N 5015.213 E 4985.486

NOTES:
 ALL EXCAVATION FOR ROADWAY SHALL BE PAID FOR UNDER THE ITEM "EARTH EXCAVATION."
 REMOVAL OF THE STONE MASONRY ENDWALL AND 36" CMP CULVERT SHALL BE PAID FOR UNDER THE ITEM "REMOVAL OF STRUCTURE."
 FOR INSTALLATION OF THE 15" R.C.P., SEE STANDARD SHEET 651-A "INSTALLATION WHERE GRAVEL FILL IS USED" TYPE I INSTALLATION.
 SEDIMENTATION CONTROL SYSTEMS SHALL BE INSTALLED AT THE BASE OF ALL FILL SLOPES. SEE SHEETS 13 AND 14 OF 33 FOR SEDIMENTATION CONTROL DETAILS.
 THE COST FOR HANDLING WATER SHALL BE PAID FOR UNDER THE ITEM "STRUCTURE EXCAVATION - EARTH (COMPLETE)"
 THE COST FOR TURBIDITY CONTROL CURTAIN SHALL BE PAID FOR UNDER THE ITEM "SEDIMENTATION CONTROL SYSTEM"

MANUAL REVISIONS TO THIS DOCUMENT ARE PROHIBITED. ALL REVISIONS MUST BE PERFORMED ON CADD FILE:
 98186_S2.dwg 07/10/02 11:09 sdrechar

NO.	DATE	REVISION
1	4/8/02	Added Watercourse Notes

DESIGNED: MEM
 DRAWN: MEM
 CHECKED: WDS
 APPROVED: WDS

DATE: MAR. 2002
 SCALE: 1"=20'

BRIDGE REHABILITATION
GALES FERRY ROAD OVER GREAT BROOK
GROTON, CONNECTICUT

ROADWAY PLAN

DESIGNED BY: **PURCELL ASSOCIATES**

SHEET NO.
2 OF 33

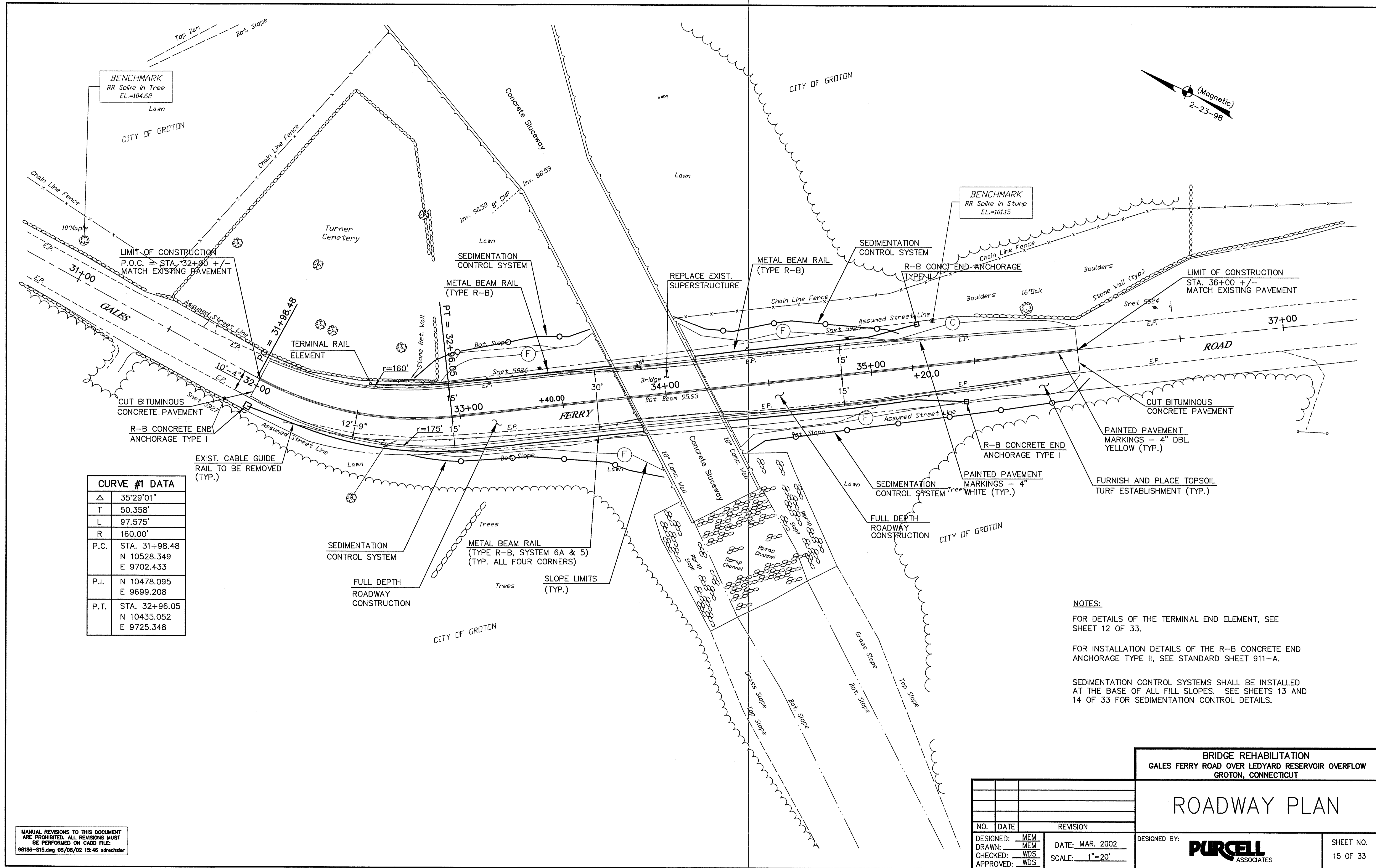

BENCHMARK
RR Spike in Tree
EL.=104.62

BENCHMARK
RR Spike in Stump
EL.=101.15

CURVE #1 DATA	
Δ	35°29'01"
T	50.358'
L	97.575'
R	160.00'
P.C.	STA. 31+98.48 N 10528.349 E 9702.433
P.I.	N 10478.095 E 9699.208
P.T.	STA. 32+96.05 N 10435.052 E 9725.348

NOTES:
 FOR DETAILS OF THE TERMINAL END ELEMENT, SEE SHEET 12 OF 33.
 FOR INSTALLATION DETAILS OF THE R-B CONCRETE END ANCHORAGE TYPE II, SEE STANDARD SHEET 911-A.
 SEDIMENTATION CONTROL SYSTEMS SHALL BE INSTALLED AT THE BASE OF ALL FILL SLOPES. SEE SHEETS 13 AND 14 OF 33 FOR SEDIMENTATION CONTROL DETAILS.

MANUAL REVISIONS TO THIS DOCUMENT ARE PROHIBITED. ALL REVISIONS MUST BE PERFORMED ON CADD FILE:
98186-S15.dwg 08/08/02 15:46 sdrechner

NO.	DATE	REVISION

BRIDGE REHABILITATION GALES FERRY ROAD OVER LEDYARD RESERVOIR OVERFLOW GROTON, CONNECTICUT	
ROADWAY PLAN	
DESIGNED BY: PURCELL ASSOCIATES	SHEET NO. 15 OF 33

DESIGNED: MEM
 DRAWN: MEM
 CHECKED: WDS
 APPROVED: WDS
 DATE: MAR. 2002
 SCALE: 1"=20'